

Compact short stroke cylinders available in single as well as double acting versions. Ideally suited for clamping and locking operations. The compact design with mounting holes through the cylinder body makes the unit easy to install in confined spaces. The main body is machined from one piece thus providing an easy to clean unit. Fitted with stainless steel piston rod as standard for corrosion resistance.



- Short stroke cylinders providing high clamping forces
- Compact dimensions for confined spaces
- Single and double acting versions
- Simple installation and mounting

### Operating information

Working pressure: Max 10 bar  
Working temperature: -20°C to +70°C

Prelubricated, further lubrication is not normally necessary. If additional lubrication is introduced it must be continued.

For more information see [www.parker.com/euro\\_pneumatic](http://www.parker.com/euro_pneumatic)

### C05 Double acting cylinders

Cyl. bore mm	Stroke mm	Port	Order code
12	10	M5	<b>C05-12-5-10</b>
20	10	M5	<b>C05-20-10-10</b>
32	10	G1/8	<b>C05-32-12-10</b>
32	25	G1/8	<b>C05-32-12-25</b>
50	25	G1/4	<b>C05-50-16-25</b>
63	25	G1/4	<b>C05-63-16-25</b>

### C05S Single acting cylinders

Cyl. bore mm	Stroke mm	Port	Order code
8	4	M5	<b>C05S-8-4-4</b>
12	4	M5	<b>C05S-12-5-4</b>
20	4	G1/8	<b>C05S-20-10-4</b>
32	5	G1/8	<b>C05S-32-12-5</b>
50	10	G1/4	<b>C05S-50-16-10</b>
63	10	G1/4	<b>C05S-63-16-10</b>

The spring forces in single acting cylinders are sufficient to return the piston without load.

Dimensions (mm), basic cylinder

Single acting

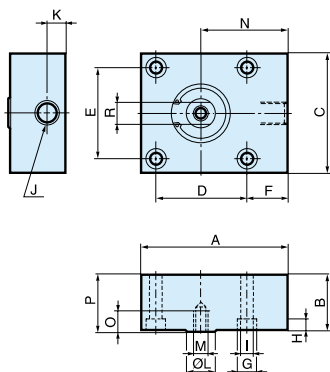

Type	A	B	C	D	E	F	G	H	I	J	K	KA	KB	L
C05S-8-4-4	20	16	18	0*	11	5,5	6	3,4	3,4	M5	5,0	-	-	4
C05S-12-5-4	25	16	20	0*	13	7,0	6	3,4	3,4	M5	6,0	-	-	5
C05S-20-10-4	40	20	32	0*	20	9,0	10	5,0	5,5	G1/8	9,5	-	-	10
C05S-32-12-5	55	26	45	0*	32	14,0	10	5,0	5,5	G1/8	9,5	-	-	12
C05S-50-16-10	80	30	65	50	50	22,5	11	6,5	6,5	G1/4	11,0	-	-	16
C05S-63-16-10	90	35	80	62	62	19,0	15	9,0	9,0	G1/4	11,0	-	-	16

Type	M	N	O	P	R
C05S-8-4-4	-	13,5	-	17	-
C05S-12-5-4	-	15,0	-	17	-
C05S-20-10-4	M5	24,0	8	21	-
C05S-32-12-5	M6	32,0	12	27	9
C05S-50-16-10	M8	47,5	12	31	14
C05S-63-16-10	M8	50,0	14	36	14

Double acting

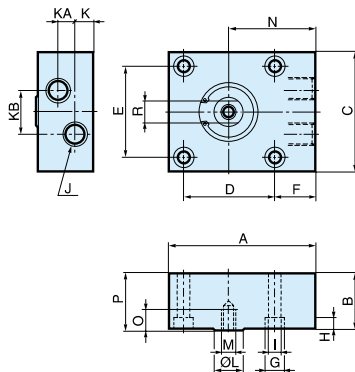

Type	A	B	C	D	E	F	G	H	I	J	K	KA	KB	L
C05-12-5-10	25	27	20	0*	13	7,0	6	3,4	3,4	M5	6,0	13,0	3	5
C05-20-10-10	40	30	32	0*	20	9,0	10	5,0	5,5	M5	6,0	16,0	6	10
C05-32-12-10	55	36	45	0*	32	14,0	10	5,0	5,5	G1/8	9,5	16,5	14	12
C05-32-12-25	55	51	45	0*	32	14,0	10	5,0	5,5	G1/8	9,5	31,5	0**	12
C05-50-16-25	80	50	65	50	50	22,5	11	6,5	6,5	G1/4	11,0	28,0	0**	16
C05-63-16-25	90	55	80	62	62	19,0	15	9,0	9,0	G1/4	11,0	33,0	0**	16

Type	M	N	O	p	R
C05-12-5-10	-	16,0	-	28	-
C05-20-10-10	M5	24,0	8	31	-
C05-32-12-10	M6	32,0	12	37	9
C05-32-12-25	M6	32,0	12	52	9
C05-50-16-25	M8	47,5	12	51	14
C05-63-16-25	M8	50,0	14	56	14

\* Only two mounting holes (F).

\*\* Connections in-line.